



EUROLINE
WINDOWS

*The Art and Practice
of Fenestration*

ENERGETO NEO



CONTEMPORARY SOLUTION

EuroLine Windows has adapted a new window and door platform for use in Canada and USA. Developed by Aluplast, energeto® neo delivers a unique combination of design, compatibility and technology.

The energeto neo system was inspired by the Bauhaus style. This style once revolutionized architecture. A simple and beautiful design for everyone. Lots of light and a combination of interior and exterior elements – themes that are as relevant as ever.

The modern and timeless surfaces along with the profile shape create a differentiated aesthetic with longevity in mind.

energeto neo is a fenestration platform that offers:

- Design: slim cubic profile
- Climate: specific to Canada and US temperature ranges
- Compatibility between systems (especially in the area of accessories)
- Modern and timeless ThermoFoil surfaces along with dark base frame options
- Zero-waste policy as target for 2026 is an Aluplast commitment to the environment

FOR THE FUTURE





JET BLACK IS THE NEW BLACK



CLASSIC BLACK

Black is a simple yet sophisticated base colour and go to designer palette choice. Monochrome, tone-in-tone living spaces have a relaxing and calming effect giving rooms a refined and puristic look. It lets other colours shine and yet does not dominate, remains in the background – simple, plain and cool.

The new and high-quality Jet-Black surface not only suits the monochrome black furnishing trend of Bauhaus-style inspired buildings, but also as a supporting element for large-scale glass façades in urban environments.

Surface is scratch-resistant and easy to clean. The patented Cool Colors plus technology prevents heat from being absorbed by the surface due to solar radiation and prevents the profiles from heating up.

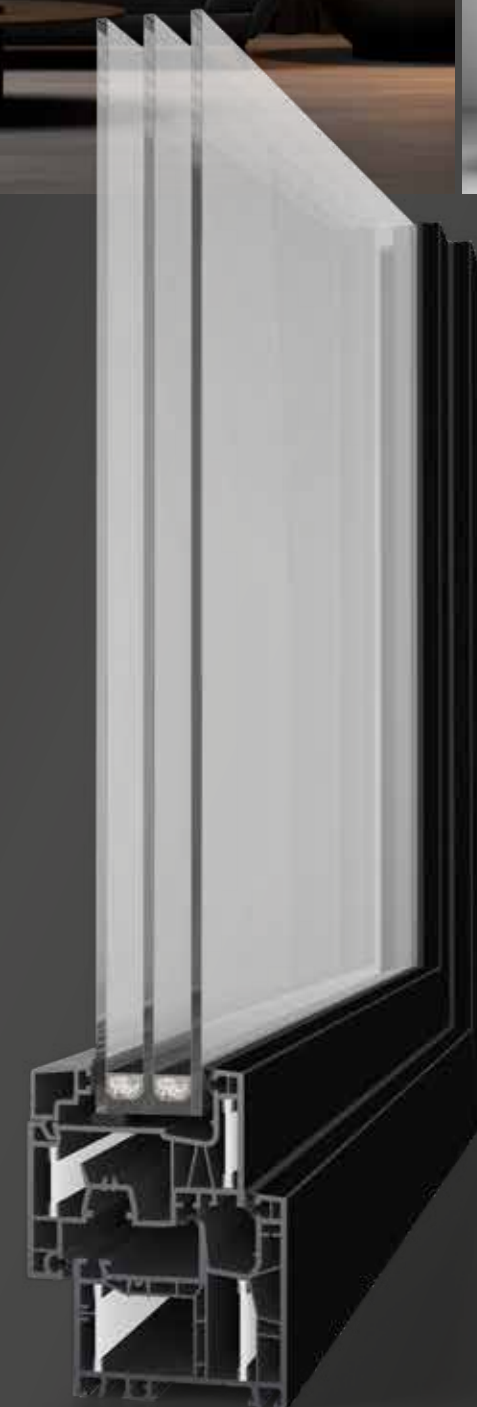



WOODEC

ALUDEC

INSPIRED BY NATURE

ThermoFoil woodec surfaces impress with deep grain and pleasant feel – it feels and looks like real wood. Light to dark tones were inspired by the Scandinavian furnishing style. In the room, the colours provide warmth and comfort. Outside, they give the house a distinguished appearance.

WINDOWS AS INDIVIDUAL AS YOUR STYLE

Windows are also becoming an integral part of interior design and spatial planning. Common options are wood and aluminum: the natural look of wood and the contemporary aluminum look. Both trends are met with woodec and aludec surfaces. It is not only visually oriented towards the natural material, woodec also feels real and can hardly be distinguished from actual wood.

Development and design were influenced by the Scandinavian countries. Lots of wood, simple shapes, straightforward designs and warm colours characterise the Scandinavian furnishing style making it the design choice.

INSPIRED BY STYLE

aludec is characterised by a perfect structure with a sand-matt finish. The surface can hardly be distinguished visually and tangibly from powder coating. The colour palette ranges from white to shades of grey and black. The timeless colours match many different building and furnishing styles – indoors and outdoors.

THE ADVANTAGE OF THERMOFOIL™



Looks and feels real: Perfect texture and grain that can be seen and felt.



Resource-saving: Saves the resources wood and aluminum and can be 100 percent recycled.



Simple elegance: The colours have been carefully selected – inspired by the Scandinavian interior style.



Scratch-resistant: Up to 10 times more scratch-resistant than a standard decor.



Versatile: aludec and woodec can be combined in many colours. They can be used indoors and outdoors.



Easy to clean: Easy cleaning of the surfaces – warm water and mild cleaners are enough.



DESIGN MEETS TECHNOLOGY

ENERGETO[®] NEO TILT AND TURN WINDOW

- $U_f = 1.00 \text{ W/m}^2\text{K}$
- $U_w = 0.90 \text{ W/m}^2\text{K}$ best possible option
- woodec and aludec as standard finish
- Powerdur inside
- Dry glazing, deep cavity
- Up to RC2 burglary protection
- Optional foam insertion

CO₂ FOOTPRINT

Saving energy, conserving resources, avoiding CO₂: energeto neo with aludec and woodec – a perfect combination for indoors and outdoors. It has never been easier and more resource-saving to acquire a uPVC window in wood/aluminium look.

SUSTAINABLE AND RECYCLABLE 
DEEP GLAZING
POWERDUR INSIDE
FOAM INSIDE



DESIGN MEETS TECHNOLOGY

NEO DOOR

- $U_f = 1.2 \text{ W/m}^2\text{K}$
- $U_w = 0.93 \text{ W/m}^2\text{K}$ best possible option1
- woodec and aludec as standard finish
- Multi-point quick latch hardware
- Barrier Free sill with integrated locking points
- PG-50 performance
- Up to RC2 burglary protection

Door shown with optional barrier free threshold.





NEO SMART-SLIDE

SIMPLE, INTUITIVE OPERATION

neo smart-slide with its modern cubic design blends in perfectly between the living space and outdoor areas. Large glass surfaces with element formats of up to 6.0 m x 2.5 m grant you a fantastic view of the outside. Easy sliding, intuitive closing and the convenient self-closing mechanism speak for themselves. Low effort meets high tightness.

FIXFRAME – LARGER VIEWS

The exceptionally narrow profile provides even more light into your living space enhancing sight lines and when desired reduces your heating costs and improves your carbon footprint.

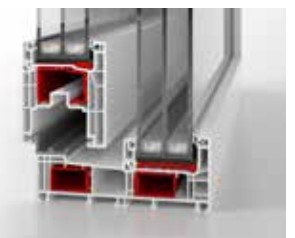

STEP PROTECTION – ROBUST SOLUTION

The additional frame profile in the lower area of the door protects the neo smart-slide from scratches, impacts and other effects. The step protection is resistant and easy to clean. This means that the sliding door will look good for years to come.

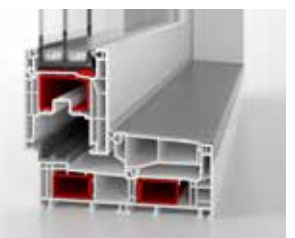



THE SMART SLIDING SOLUTION IN A MODERN CUBIC DESIGN



DESIGN MEETS TECHNOLOGY

NEO SMART-SLIDE

- Low installation depth of 78 mm or 154 mm
- $U_f = 1.3 \text{ W/m}^2\text{K}$
- $U_w = 0.97 \text{ W/m}^2\text{K}$
- Available in configurations XO, OXO, OXXO
- Integrated hardware technology moving multi-point locking with compression gaskets
- Available in dark and white base
- woodec and aludec standard finishes
- Accomodates up to 54mm OA Glazing Units

ALUDEC SURFACE
JET BLACK MATT



GLAZING PERFORMANCE

As building codes advance and projects require thermal performance large triple glazing is the answer.

Insulated Glazing Units (IGUs) up to 54mm can be accommodated in the system allowing the largest triple glazed units to be easily fitted. Larger IGUs provide strength and security while maintaining desired performance. energeto neo is built with significant reinforcement capabilities to accommodate the weight of extremely large IGUs with both steel or fiberglass strengthening. Warm edge spacer (Tri-Seal Super Spacer), wide selection of Low-E glass specific to North America climates provided by Cardinal.

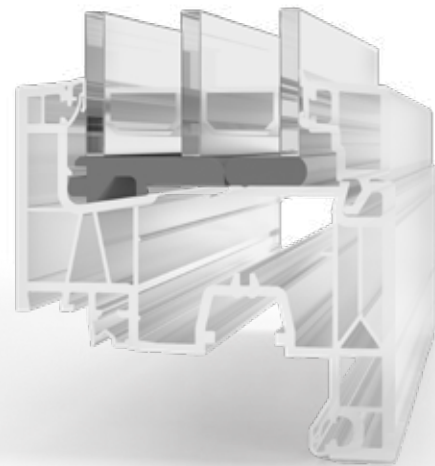

SAFETEC INSIDE

A smart way to thwart attempted break-ins

Along with multi-point locking a third gasket in the window frame creates the fixed central web running all around the frame. This ensures improved thermal insulation values and prevents the sash from being levered open.

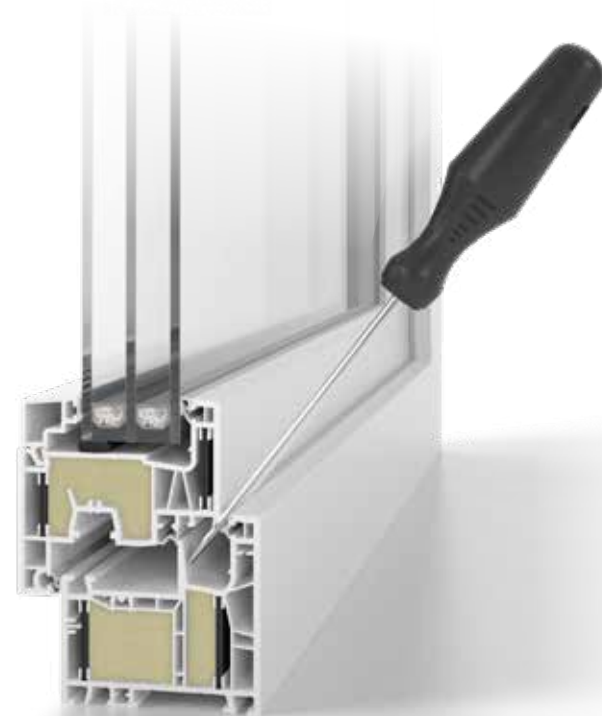

POWERDUR® INSIDE

For the best heat insulation

Reduce steel to a minimum or even eliminate it altogether – In cooperation with BASF, a special glass-fibre reinforced material was developed that provides the necessary stability inside the profiles. Significantly better insulation values are achieved with powerdur, which is inserted directly into the profile during the extrusion process.

The profiles are 100 percent recyclable. In state-of-the-art aluplast recycling plants, the granulated PVC can be separated accurately from the powerdur material and fed back into the production cycle several times.

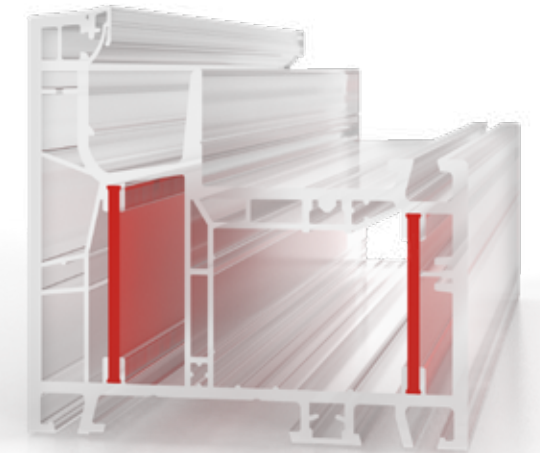

FOAM INSIDE

Window technology at its best

Impressive insulation values are made possible by foam inside technology. The profile chambers are filled with special rigid foam where needed for superior thermal performance. The exact requirements are calculated using software provided by aluplast. Note that foam is completely recyclable, because it is slid into the profiles and not bonded to the other profile materials.

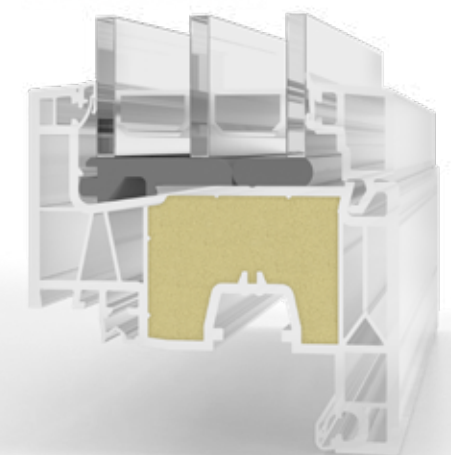



EUROLINE
W I N D O W S

*The Art and Practice
of Fenestration*

